

RSH Radial Lead Type

series

- Higher temperature endurance guaranteed than RS series
- Low ESR, High ripple current
- Load life of 1,000h at 125°C

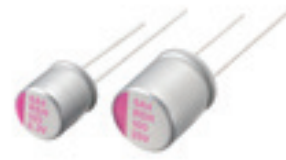

SPECIFICATIONS

Items	Characteristics	
Temperature range	-55 to +125°C	
Rated voltage range	2.5 to 25Vdc	
Capacitance range	6.8 to 1,500μF	
Capacitance tolerance	±20% [M] (at 20°C, 120Hz)	
Tangent of loss angle	Less than or equal to the value of Standard Ratings (at 20°C, 120Hz)	
Leakage current	Less than or equal to the value of Standard Ratings (at 20°C, after 2 minutes)	
ESR	Less than or equal to the value of Standard Ratings	
Characteristics of impedance	Z _{+125°C/Z_{+20°C} ≤ 1.25, Z_{-55°C/Z_{+20°C} ≤ 1.25 at 100kHz}}	
Endurance	125°C, 1,000 hrs at rated voltage	
	Appearance	No significant damage
	Capacitance change	Within±20% of the initial value
	Tangent of loss angle (tanδ)	≤150% of the initial specified value
	ESR(mΩ)	≤150% of the initial specified value
	Leakage current	≤The initial specified value
Damp Heat (Steady State)	60°C, 90 to 95% RH, 1,000 hrs, No-applied Voltage	
	Appearance	No significant damage
	Capacitance change	Within±20% of the initial value
	Tangent of loss angle (tanδ)	≤150% of the initial specified value
	ESR(mΩ)	≤150% of the initial specified value
	Leakage current	≤The initial specified value
Resistance to soldering heat	Flow method (260±5°C, 10s)	
	Appearance	No significant damage
	Capacitance change	Within±10% of the initial value
	Tangent of loss angle (tanδ)	≤130% of the initial specified value
	ESR(mΩ)	≤130% of the initial specified value
	Leakage current	≤The initial specified value

*In case of some problems for measured values, measure after applying rated voltage for 120 minutes at 125°C

SIZE LIST

(unit : mm)

μF	RV(SV)	2.5 (3.3)	4 (5.2)	6.3 (8.2)	10 (11.5)	16 (18.4)	20 (23.0)	25 (28.7)
6.8								6.3 x 6
10								8 x 7
22							6.3 x 6	10 x 8
33							8 x 7	8 x 11.5
39						6.3 x 6		
47						6.3 x 6	8 x 7	
56					6.3 x 6		10 x 8	10 x 11.5
68							10 x 8	
82				6.3 x 6		8 x 7		
100			6.3 x 6	6.3 x 6		8 x 7	10 x 8 8 x 11.5	8 x 11.5
120					8 x 7			
150			6.3 x 6	8 x 7	8 x 7	10 x 8	10 x 11.5	10 x 11.5
180						8 x 11.5		
220			8 x 7	8 x 7				
270					10 x 8			
330			8 x 7	10 x 8	8 x 11.5	10 x 11.5		
470			10 x 8	8 x 11.5		10 x 11.5		
560			8 x 11.5		10 x 11.5			
680	8 x 11.5	10 x 8						
820				10 x 11.5				
1000				10 x 11.5				
1200		10 x 11.5						
1500	10 x 11.5							

*RV : Rated Voltage [V] SV : Surge Voltage [V] (at room temperature)

MARKING AND DIMENSIONS

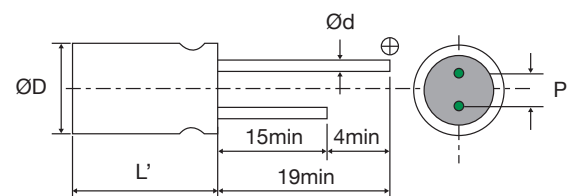

(unit : mm)

Size	ØD±0.5	L	L'	P±0.5	Ød
6.3 x 6	6.3	6.0		2.5	0.45
8 x 7	8.0	7.0	L max.	3.5	0.45
10 x 8	10.0	8.0		5.0	0.60
8 x 11.5	8.0	11.5	L+1.0max.	3.5	0.60
10 x 11.5	10.0	11.5		5.0	0.60

Conductive Polymer Aluminum Capacitors

STANDARD RATINGS

Rated Voltage [Vdc]	Rated Capacitance [µF]	Size Φ D x L [mm]	ESR (20°C, 100kHz) [mΩ] [max.]	Rated Ripple Current (100kHz) [mA rms]		Tangent of Loss Angel [max.]	Leakage Current [µA, max.]	Part Number
				-55 to +105°C	+105 to +125°C			
2.5	680	8 x 11.5	13	4520	1430	0.10	340	2RSH680MD11
	1500	10 x 11.5	13	5440	1721	0.10	750	2RSH1500ME11
4	100	6.3 x 6	40	1810	572	0.10	200	4RSH100MC6
	150	6.3 x 6	40	1810	572	0.10	300	4RSH150MC6
	220	8 x 7	35	2560	810	0.10	440	4RSH220MD7
	330	8 x 7	35	2560	810	0.10	660	4RSH330MD7
	470	10 x 8	25	3700	1170	0.10	376	4RSH470ME8
	560	8 x 11.5	13	4520	1430	0.10	448	4RSH560MD11
	680	10 x 8	25	3700	1170	0.10	544	4RSH680ME8
	1200	10 x 11.5	13	5440	1721	0.10	960	4RSH1200ME11
6.3	82	6.3 x 6	45	1700	537	0.10	258	6RSH82MC6
	100	6.3 x 6	40	1810	572	0.10	315	6RSH100MC6
	150	8 x 7	35	2560	810	0.10	472	6RSH150MD7
	220	8 x 7	35	2560	810	0.10	693	6RSH220MD7
	330	10 x 8	25	3700	1170	0.10	416	6RSH330ME8
	470	8 x 11.5	15	4210	1332	0.10	592	6RSH470MD11
	820	10 x 11.5	12	5440	1721	0.10	1033	6RSH820ME11
	1000	10 x 11.5	12	5440	1721	0.10	1260	6RSH1000ME11
10	56	6.3 x 6	45	1700	537	0.10	280	10RSH56MC6
	120	8 x 7	35	2560	810	0.10	600	10RSH120MD7
	150	8 x 7	35	2560	810	0.10	750	10RSH150MD7
	270	10 x 8	25	3700	1170	0.10	540	10RSH270ME8
	330	8 x 11.5	17	3950	1250	0.10	660	10RSH330MD11
	560	10 x 11.5	13	5230	1655	0.10	1120	10RSH560ME11
	16	6.3 x 6	50	1620	512	0.10	312	16RSH39MC6
16	47	6.3 x 6	50	1620	512	0.10	376	16RSH47MC6
	82	8 x 7	40	2120	670	0.10	656	16RSH82MD7
	100	8 x 7	40	2120	670	0.10	800	16RSH100MD7
	150	10 x 8	30	3020	955	0.10	480	16RSH150ME8
	180	8 x 11.5	20	3640	1151	0.10	576	16RSH180MD11
	330	10 x 11.5	16	4720	1493	0.10	1056	16RSH330ME11
	470	10 x 11.5	16	4720	1493	0.10	1504	16RSH470ME11
	20	6.3 x 6	60	1450	458	0.10	220	20RSH22MC6
20	33	8 x 7	45	1890	598	0.10	330	20RSH33MD7
	47	8 x 7	45	1890	598	0.10	470	20RSH47MD7
	56	10 x 8	40	2400	759	0.10	224	20RSH56ME8
	68	10 x 8	40	2400	759	0.10	272	20RSH68ME8
	100	10 x 8	35	2570	810	0.10	400	20RSH100ME8
	100	8 x 11.5	24	3320	1050	0.10	400	20RSH100MD11
	150	10 x 11.5	20	4320	1367	0.10	600	20RSH150ME11
	25	6.8	6.3 x 6	80	1200	377	0.10	170
25	10	8 x 7	60	1500	471	0.10	250	25RSH10MD7
	22	10 x 8	50	2000	632	0.10	275	25RSH22ME8
	33	8 x 11.5	30	2980	943	0.10	413	25RSH33MD11
	56	10 x 11.5	28	3800	1202	0.10	700	25RSH56ME11
	100	8 x 11.5	30	3320	1050	0.10	500	25RSH100MD11
	150	10 x 11.5	25	4320	1367	0.10	750	25RSH150ME11